

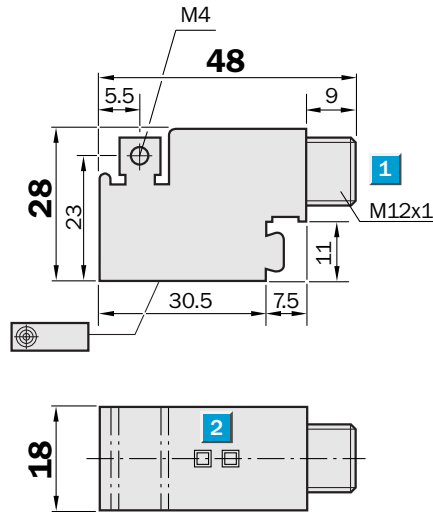

- Weld immune in welding applications
- The sensors locks the output during the welding process. When the welding process stops, the sensor updates the output accordingly
- Flexible mounting technique for different cylinder styles
- Housing with teflon coating optional

Dimensional drawing



- 1 Connection
- 2 Display LED



Connection type

- MZU2-03VPS-DCM
- MZU2-03VPS-TCM

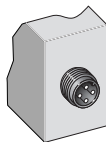

M12, 4-pin

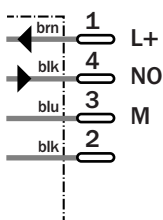

See chapter Accessories
 Connector, M12, 4-pin
 Mounting systems

Technical data		MZU2-	03VPS -DCM	03VPS -TCM								
Sensing face	Front											
Electrical configuration	DC 3-wire											
Supply voltage V_s	DC 10 ... 30 V											
Response sensitivity	≤ 3 mT											
Residual ripple V_{pp}	≤ 10 % ¹⁾											
Voltage drop V_d	≤ 2 V											
Power consumption	≤ 18 mA ²⁾											
Continuous current I_a	≤ 300 mA											
Time delay before availability t_v	≤ 20 ms											
Hysteresis H, of s_r	≤ 1.5 mm											
Repeatability R	≤ 0.1 mm (U_b and T_a constant)											
EMC	According to EN 60947-5-2											
Switching output	PNP											
Output function	Normally open											
Connection type	Connector, M12, 4-pin											
Enclosure rating	IP 67 ³⁾											
Max. switching frequency	40 Hz											
Wire-break protection	✓											
Short circuit protection	✓ ⁴⁾											
Reverse polarity protection	✓											
Power-up pulse suppression	✓											
Shock/vibration stress	30 g, 11 ms / 10 ... 55 Hz, 1 mm											
Ambient operating temperature T_a	-25 °C ... +75 °C											
Housing material	Zinc die cast/Teflon coated											
	Zinc die-cast											

¹⁾ of U_b

²⁾ without load

³⁾ according to EN 60529

⁴⁾ (pulsed)

Mounting clamp for pneumatic cylinder sensor MZU2

Mounting clamp:	BEF-KS-U2-S1
Material:	Zinc die-cast
Order no.:	4 030 922
Mounting clamp:	BEF-KS-U2-S1T
Material:	Zinc die-cast with teflon coating
Order no.:	4 031 632
Tie-rod cylinder $\varnothing 4$... 20 mm	

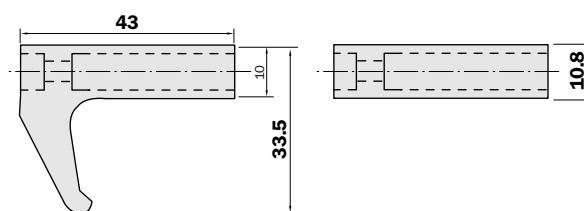

Order information

Type	Order no.
MZU2-03VPS-DCM	1 017 450
MZU2-03VPS-TCM	1 017 451